



A NIGHT
UNDER ✨
THE STARS

To benefit East End Hospice

SUMMER GALA 2022

Saturday, June 25th

...

40 SECOND NECK LANE
QUOGUE, NEW YORK

BERTSAND

Plumbing & Heating, Inc.

Proud to Support East End Hospice

2087 Osborne Avenue • Calverton, NY 11933

631.208.8400 office • 631.208.8411 fax

Robert Bertorello
Robert Bertorello III





481 Westhampton-Riverhead Road
Post Office Box 1048
Westhampton Beach, NY 11978-7048

631-288-8400
631-288-8492 FAX
www.eeh.org



Dear Friends:

Welcome back to Second Neck Lane. Thank you for joining us for “A Night Under the Stars” in support of East End Hospice. It is wonderful to see friends old and new as we celebrate our community’s incredible resiliency and East End Hospice’s exciting future.

We are caring for more patients than ever before in our history. The demand for our services has grown substantially as the East End population booms, and the healthcare landscape continues to shift. EEH is the only hospice provider on the East End, and our community needs us now more than ever.

In 2021, we cared for 751 hospice patients and 350 bereavement clients across 450 square miles from Montauk to Mastic and everywhere in between. Growing demand has meant increasing the size of our team and adding new services, like our popular music therapy program and our first-ever Spanish-language bereavement group. It also means building a new home for EEH.

Our new EEH Headquarters will allow us to bring the Zinberg Family Bereavement Center, community spaces, clinical services, and administrative functions under one roof. It reimagines our Kanas Center for Hospice Care’s thoughtful design elements and applies them to areas specially designed for grief and bereavement. The new EEH Headquarters will allow us to meet current needs and plan for a future when even greater numbers of East End residents benefit from EEH’s nationally recognized model of care.

I invite you to learn more about the project by reaching out to me directly or speaking with a member of our Board of Directors or Development Team. Thank you for your partnership in our work. I look forward to launching this new project with you.

With gratitude,

Mary Crosby, RN, MPH, CHPN
President & CEO

PLATINUM

Mr. & Mrs. John V. Brennan • John & Elaine Kanas Family Foundation • Stanley Zinberg, MD

ANGEL

Bobbie Braun - The Neuwirth Foundation • Howard & Wendy Cox • Mary I. and John E. Hull • Reuben and Robin Jeffery

BENEFACTOR

Eileen & Frank Boccio • Trish Metz, Morgan Stanley

PATRON

Patty Allen
Susan K. Allen
Mr. & Mrs. Thomas P. Borger
Brown Harris Stevens
Nancy Calcagnini
Kevin & Sandy Crowe
Thomas Diffley
The Edwards Family

Lori & Jeffrey Feldman
Ann & Dennis Fitzsimons
Patricia Garrity, The Corcoran Group
Paul D. Kazilionis & Christina A. Boothe
Cristina & David Kepner
Nancy & Luke P. LaValle, Jr.
Trish & Pete Meyers
Carol Lee & James Nespole

The Otis Family
Paula & Steve Palumbo
Drs. Elizabeth & Louis Pizzarello
Mr. & Mrs. Thomas B. Poole
Paul J. Powers Jr. & Tina A. Davis
Kenny & Maggie Rosenberg
Robert & Nancy Treuhold

SPONSOR

Mike & Renee Barriere
Mr. & Mrs. Matthew Blank
Jane Busking
Betty Ann Catanzaro
Tony Catanzaro
Daniel Gale Sotheby's International Realty
Mr. & Mrs. R. Zachary Epley
Scott K. Glasser, Clearbridge Investments, LLC
Hampton Pest Management
Christiane Hiegel
Ann Liguori Foundation

Charles & Anne Mott
Roanoke Sand & Gravel
David & Betsy Webb Rowe
Barbara & Peter Sartorius
Lora & John Schiavetta
Susan & Gene Shanks
Louise R. Smith
Mr. & Mrs. Kelso F. Sutton
Irene Truskolaski
Rose Lowe & Gary Weber

DONOR

Anonymous
Dr. & Mrs. Louis J. Avvento
Beach Dental
Eileen Brod & Alan Kessler
Arlene Buejse
Randy & Beverly Cardo
Hiriam S. Cody III MD
Mary & Hilton Crosby
Hon. John Czygier
Peggy DeMayo
Dorothy Donneson
Nelson DeMille
Yvonne Elliman
Mr. & Mrs. Anthony Ettorre
Mr. & Mrs. Joseph Gazza
Alexis B. Gersten & Jason M. Parli
Joe & Peggy Giaquinto

Paul & Nina Goodwin
Lorrie & Harold Gordon
Janis & Richard Grim
Peter & Michelle Halstead
Mr. & Mrs. Scott Hofmann
Ann Kaplan & Robert Fippinger
Ben & Sandy Karlin
Mr. & Mrs. Robert E. Kennedy
Maureen & Tony Leness
Anne Licursi
Mrs. Jered M. Lynch
Sheila McCauley
Elizabeth McCourt & Michael George
Sharon & Tom McGavin
Lisa & Jim Mendelson
Harrison Messer
Mark & Elizabeth Meyer

Betsy Miller & Stuart F. Sucherman
Sally & Thomas Neff
Joseph & Carol Nemeth
Linda & Joseph Perrotta
Susan H. Perkins
Mr. & Mrs. Vincent T. Pica
Sally Richardson
Peter Romano
Rooted Hospitality Group
Jill & Brendan Ryan
Karen Torns
Michael Twomey & Jeannine Dowling
Alexandra S. Urdang & Irwin W. Messer
William & Joyce O'Neil Charitable Trust
Kathe & Edwin Williamson
Allison & Ralph Worthington
Woodcliff Park Cottages

Please forgive any omission, list incomplete at time of printing



481 Westhampton-Riverhead Road
Post Office Box 1048
Westhampton Beach, NY 11978-7048

631-288-8400
631-288-8492 FAX
www.eeh.org

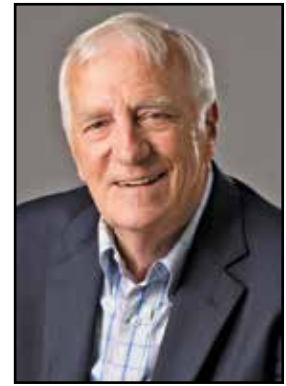

Dear Friends:

What a pleasure to once again celebrate East End Hospice's incredible care for our community and your vital partnership in our work. Your support improves the lives of hundreds of friends and neighbors each year who rely on EEH for hospice and bereavement care.

Our Gala Committee members make our celebration possible. Led by Co-Chairs Paula Palumbo and Thomas Diffley, they've considered every detail to make tonight a spectacular success. Thank you. Thanks also to Robin and Reuben Jeffrey, who, once again, have generously opened their home to Hospice. This evening, the stars reflecting on the bay remind us of our connection to those no longer with us.

We remember our Honorary Chair, Starr Boggs, who sustained us with good food, great conversation and a generous spirit, making him a friend to all who knew him. A night like tonight is a fitting tribute to Starr, who defined East End hospitality. We celebrate the Otis Family of Quogue, our Dorothy P. Savage Good Samaritan Award recipients. Like Dorothy herself, the Otises are passionately committed to our community.

East End Hospice touches so many lives across the East End and beyond because of our generous supporters, dedicated volunteers, including my colleagues on the Board of Directors, and expert staff. They are leaders in the fields of hospice care and bereavement services.

Mary Crosby, President & CEO, oversees our extraordinary work. Her impressive leadership these past few years is surpassed only by her enthusiasm for our future. EEH is positioned to care for growing numbers of hospice patients, their families, friends and caregivers and meet our community's rapidly increasing need for grief and bereavement support.

Thank you for taking part in our "Night Under the Stars." We're honored that you chose to launch your summer season with us. Tonight we celebrate East End Hospice's vital contributions to the well-being of our community. You make our work possible. Thank you!

Sincerely,

Peter C. Halstead
Chairman

East End Hospice Board of Directors 2022



Peter C. Halstead, *Chairman*

Peter is a residential real estate appraiser. He retired after a 30+ career as a commercial pilot and captain. He previously served in the U.S. Navy as Lieutenant Aviator. He and his wife, Michelle, an East End Hospice volunteer, enjoy cooking, traveling and spending time with their children and grandchildren. They reside in Remsenburg.



Rajesh C. Patel, MD, *Vice Chairman*

Dr. Patel is a pulmonologist and critical care practitioner with Eastern Suffolk Pulmonology and Peconic Bay Medical Center. He volunteers with International Surgical Mission Support (ISMS), providing expert medical care to those in need worldwide. Dr. Patel enjoys spending time with his wife, Shoba Patel, MD, and their two sons, former Camp Good Grief volunteers. He lives in Quogue.



Michael Merlo, *Treasurer*

Mike is the former Executive Vice President and Chief Credit Officer at Signature Bank. He serves on the Board of Directors of New York Institute of Technology and the Tomorrow's Hope Foundation. He and his wife, Gerri, an EEH volunteer, divide their time between Westhampton Beach and Naples.



Elizabeth Webb Rowe, *Secretary*

Betsy volunteers with numerous East End and New York-based nonprofits. She worked as a legal assistant supervisor before retiring in 2001. Betsy enjoys traveling and spending time with her husband, David, and their two children. She is a proud fourth generation Remsenburg resident who now divides her time between New York City and Quogue.



Gabrielle Bamberger

Gay heads Gabrielle Bamberger Public Relations, a firm she founded and has run since the late-1960s. She has developed PR plans and programs for a broad range of for-profit and nonprofit clients. Gay serves on the Board of The Center for Fiction and enjoys traveling, tennis, and spending time with friends and family. She divides her time between New York City and East Hampton.



Arlene Bujese

Arlene is a former educator, curator and Washington, DC-based art gallery director. She owned the Arlene Bujese Gallery in East Hampton for 12 years. Arlene was instrumental in securing and curating the permanent art collection at EEH's Kanas Center for Hospice Care. In addition to her love for art, Arlene enjoys gardening. She resides in East Hampton.



Hon. John Czygier, Jr.

Judge Czygier is Senior Counsel with Lewis Johs Avallone Aviles LLP; his practice areas include Trusts, Estates and Elder Law. He was appointed Judge of the Surrogate's Court of Suffolk County in May of 2001 by Governor George Pataki following twenty-five years in private practice. He was elected to that position in November of that year, and re-elected in 2011, serving until his retirement from the bench in 2018. He has served in various leadership roles for the Surrogate's Association of the State of New York and as Chair of the Hofstra Law School Distinguished Alumni on the Bench. He lives in Remsenburg.

East End Hospice Board of Directors 2022



R. Zachary Epley

Zach is Corporate Director of Support Services at Seaford Center, an alcohol and substance abuse treatment facility in Westhampton. He is a Southampton Fire Department volunteer, Vice President of the Board of Directors of Southampton Youth Services and a Trustee of the Southampton History Museum. He, his wife, Brittney, and four young children live in Southampton.



Melissa Kanas

Melissa is Trial Director of The Legal Aid Society of Suffolk County. She has worked as a public defender for various organizations, including the Criminal Tribunal for Rwanda, The Legal Aid Society of New York City and the San Francisco Public Defender's Office. Melissa enjoys spending time with her family, friends, three dogs and two cats. She lives in Remsenburg.



Anthony Meyers

Tony volunteers for several East End charities, including Southampton Hospital. He retired in 1990 after a career on the NASDAQ trading desk. He enjoys playing golf and spending time with his wife, Nannette, an EEH volunteer, his six children and their families. He lives in Southampton.



Pete Meyers

Pete Meyers is Chief Financial Officer of Slayback Pharma LLC. He has over twenty-five years of experience in the health care industry, including roles as CFO at Eagle Pharmaceuticals, Motif BioSciences and TetraLogic Pharmaceuticals Corporation. Pete serves as Chairman and President of The Thomas M. Brennan Memorial Foundation. He enjoys playing hockey and spending time with friends and family. He divides his time between Westchester and Southampton with his wife, Trish, and their two children.



Carol Lee Nespole

Carol Lee served as Director of Purchasing and later as Assistant to the Director of Development at the Trinity School. She supports numerous East End nonprofits. Carol Lee enjoys spending time with family and friends. She and her husband, Jim, live in Remsenburg.



Sally Richardson

Sally Richardson is Publisher at Large of the Macmillan Publishing Group. She was previously, chairman, president and publisher of St. Martin's Publishing Group among other roles in her more than fifty-year career with Macmillan Publishing Group. Sally is a New York Public Library volunteer. She divides her time between New York City and Remsenburg.



Jacalyn Weinstein

Jackie is a licensed clinical social worker in psychiatry at Mount Sinai Hospital in NYC. She is a founding Chair of EEH's Valentine Salon Luncheon. Since its beginning 23 years ago, it continues to be the only EEH fundraising event that solely benefits Camp Good Grief. Prior to her social work career, Jackie was active in a family-owned wholesale and retail sporting goods business on Long Island. Jackie enjoys spending time with friends and family. She lives in New York City.



Mary C. Crosby, RN, MPH, CHPN, *President & CEO*

Mary is President & CEO of East End Hospice. Mary has an extensive background in clinical care, healthcare research and project management. She previously held positions at Memorial Sloan Kettering Cancer Center and the United Nations.

Mary was born and raised in Southampton, New York and returned to the region in 2014. Prior to assuming the role of President & CEO, she worked as a Hospice nurse and later as Nurse Manager of EEH's in-patient facility, the Kanas Center for Hospice Care. She holds degrees from the College of the Holy Cross, Columbia University and New York University's School of Nursing. She resides in Southampton with her husband, Hilton, and their two sons.



Louis J. Avvento, MD, *Medical Director*

Dr. Avvento has been the Medical Director of East End Hospice since 1990. He oversees individual plans of care for each hospice patient in consultation with their primary care provider. Dr. Avvento is an oncologist with New York Cancer & Blood Specialists. He is the former Director of Palliative Care at Peconic Bay Medical Center and Stony Brook Southampton Hospital.

Dr. Avvento is board certified in Internal Medicine, Hematology and Hospice, Medical Oncology and Palliative Care. Dr. Avvento attended New York University and received his medical degree from the University of Rome.

MISSION

East End Hospice is dedicated to improving lives across Eastern Long Island through expert care, comfort and compassion for terminally ill patients and their families.



ABOUT

East End Hospice is the leading and most comprehensive provider of hospice services for Eastern Long Island. Conceived as a grassroots effort to support friends and neighbors, EEH has grown exponentially. Our care covers 450 square miles, including Southampton, East Hampton, Southold, Riverhead and Eastern Brookhaven Townships and Fishers and Shelter Islands.

EEH is certified by the New York State Department of Health and the Centers for Medicare and Medicaid. EEH maintains high satisfaction ratings from patient families and bereavement clients and routinely meets or exceeds national care delivery benchmarks

East End Hospice's licensed, professional staff and dedicated volunteers care for more than 750 terminally ill patients and 350 bereavement clients each year.

East End Hospice 1991 Society

The 1991 Society celebrates and honors those who generously include East End Hospice in their charitable estate plans.

Named to reflect the year of East End Hospice's certification, the Society allows East End Hospice to publicly thank those who thoughtfully invest in EEH's future. If you have named East End Hospice as beneficiary of your will, life insurance policy, charitable trust or similar plan, please share your intentions with us, so that we can recognize your commitment to improving lives across Eastern Long Island.

Anonymous (8)

Louis Auer
Frank J. Abbadessa
Theodosia Arkus
Karl H. Behr

Clorinda Bonaccorso

Ralph H. Burack
Byron Chandler
Elizabeth M. Desch
Anthony T. Digate
William E. Dillmeier
Eleanor Dix
Carole Donlin
Sallie M. Donnellan
Laura Delano Eastman
Christine D. Ehlers

Yvonne S. Elliman

Mary Joan Fisher
William F. R. Foote
Ethel Freiman
Jean Freifeld
Roann B. Frankel
Ernest Furtado
Beverly George
William George
Sarah Lee Girona
Marjorie L. Glennon
Carol Gristina
Virginia F. Gurnee
Patricia D. Harriton
Mary Kane Hayes
Edwin A. Hedges
Doris Hilpert

Dorothy Hines
Frances E. Hitchon
Jean K. Hoffmann
Francis E. Hoopes
Eric W. Hurner
Jane S. Innes
Pasquale Iorio
Margaret F. Jackson
Henry H. Jagger
Julius F. Jezek
Barbara H. Jordan
Eleanor F. Jorgensen
Suzanne M. Jelley
Virginia M. Knapp
Virginia W. Kroepel
Norman Leo Leavitt
Jean C. Lauer
Douglas Corwin Morris
Carol Morrison
Joan Stratton Murphey
Charlene Nederlander
T. Decker Orr
Allen D. Patterson
Eleanor S. Patterson
Anne E. C. Porter
Marion Porter
William H. Price, Sr.
Stephanie Prigge
Willis A. Pyle
William A. Quinn
Frances E. Raff
Sally Richardson
William D. Roberts

Richard Ryan
Joseph D. Ryle
Dorothy Pell Savage
Erwin Schweiger
Joanne C. Seguino
Susan M. Seidman
Viola Adele Southwood
Josephine E. Spencer
Arthur J. Steel
Eva R. Stern
Vernon G. Strub
Rita Bartlett Strand
Barbara Stuchinski
Derith D. Sutherland
Janet T. Swanson
William T. Swanson
Samuel H. Swint, Jr.
Isabel Thompson
Leona Torkelsen
Stephen Torkelsen
Joan M. Trabulsi
Doris Weber
Marie J. Wennerholm
Helen M. Wettereau
Madeline D. White
Victor Whitlock
Margaret C. Wilson
A. Gordon Wooten, Jr.
Dorothy Wormser
Joseph G. Worth
Gibson Bain Young

Bold indicates living member.

Please forgive any omission, list incomplete at time of printing



**21st Annual Dorothy P. Savage
Good Samaritan Award Recipient
THE OTIS FAMILY**



Otis Ford has served the local community for over 75 years and was founded in 1946 by Edward T. (Bob) Otis Jr “at the light” in Quogue. From the start, being in a small town, his focus was on caring for customers and the local community. The current Otis family consists of Tom and Jane Otis and their children , Beth (married to James Miller), Mary, (married to Bryan Beasley), and Tom (married to Kim Otis).

Bob was the first president of Westhampton’s Rotary Club in 1953 and a 59-year member of the Quogue Fire Department. His son Edward T. (Tom) Otis III joined him in 1969 continuing the legacy of service both at the dealership and through the Rotary Club, Quogue School Board, Quogue Fire Dept (50 years in 2022), and countless other endeavors earning him the honor of Grand Marshal of the WHB St. Patrick’s Day Parade in 2013.

Edward T. (Tom) Otis IV became the third generation in 2012. Otis Ford is proud to have many long-time employees and customers, having won Ford’s President’s Award for Customer Satisfaction 23 times, including 16 of the last 20 years and the previous 6 in a row.

Our family believes in the importance of service to the community. Tom and Jane Otis have always been active members of the Westhampton Presbyterian Church. Jane served on the Quogue Library Board for over 20 years. Edward T. (Tom) Otis IV has continued his family’s legacy of service, becoming a member of the Quogue Fire Department in 2014 and currently serves as the first lieutenant. Tom coaches his son’s baseball team and is happy to help in the community wherever he can. James has also continued the family’s legacy of service, joining the Quogue Fire Department in 2018 and currently serving on the Board of East Little League.

Tom and Kim have served on East End’s Hospice Gala Committee and the Quogue Wildlife Refuge’s Gala Committee for the last seven years. Kim has followed in her mother-in-law, Jane’s, footsteps by serving as a Co-president of the Quogue School PTA for two years. Jane was actively involved in the PTA, also serving as President, while her kids attended Quogue school. Beth and James Miller also served as members of the Quogue PTA Board. Mary and Bryan Beasley are passionate about supporting youth leadership and youth sports in the Westhampton community and across the Island both professionally, through their family owned business, and personally through their Thankful Hearts Project. “We feel so blessed that our family is able to serve our community. It’s a privilege to be able to do so and show our children at a young age the importance of helping others and the value of service to the community. Over and over, I see the truth in the saying “it takes a village,”” says Kim Otis.

Our family takes special pride in supporting East End Hospice and the incredible work that it does. Providing compassionate care when families need it most, the end-of-life care and bereavement services that East End Hospice provides are unparalleled. It is truly something exceptional to be a part of. Our family personally, and our friends, have experienced Hospice’s care for our loved ones, and it is something unlike anything else in a time that is one of the hardest. Tonight, we celebrate East End Hospice and the invaluable service they provide to our community, and we thank you for your generous support. Let’s support, donate, and have a WONDERFUL night!

**IN LOVING MEMORY
OF
STARR BOGGS**

**2022
HONORARY CHAIRPERSON**

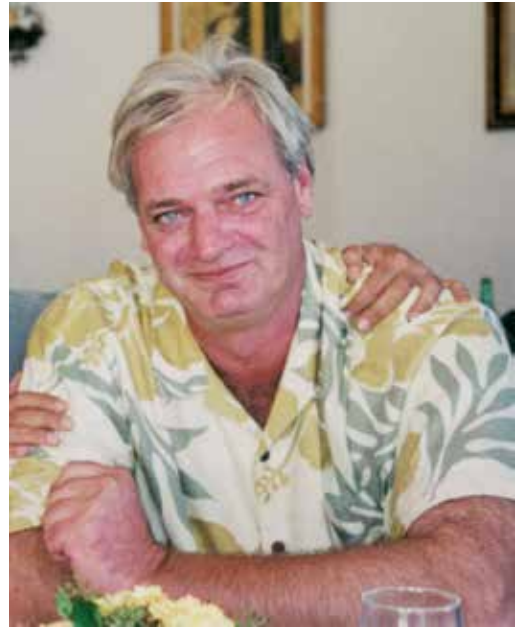

Starr Boggs was a Westhampton legend.

Since 1985, his critically-acclaimed restaurant was one of the most popular food destinations in the Hamptons, and his charm and generosity made him a truly beloved member of our community.

Starr donated and catered the food for our East End Hospice Gala for many years.

**We are truly heartbroken by his loss,
and proud to name him
our Honorary Chairperson for 2022.**



481 Westhampton-Riverhead Road
Post Office Box 1048
Westhampton Beach, NY 11978-7048

631-288-8400
631-288-8492 FAX
www.eeh.org



Dear Friends of East End Hospice,

After a two-year hiatus, we are so excited to finally host a live EEH Gala again. The event is sure to be a night to remember, with good friends, great food, and fabulous entertainment, all of us there to support a most worthy cause, the East End Hospice.

Each year, so many people work tirelessly to make this Gala one of the premier events of the season. This year is no exception:

Our honoree this year is Westhampton's own Starr Boggs, who's recent sudden passing was heartbreaking for our East End community. He was a tireless supporter of the Hospice and so many other local charities and his memory will be indelibly inked into our hearts forever.

And congratulations to the Otis Family, the recipient of our Good Samaritan Award. The Otis family continues to give back to the community year after year in so many ways...financially, as Volunteers in our Quogue Fire Department, providing transportation to the attendees of the Gala, as committee members to our EEH family. They are the quintessential example of what it means to be true Citizens of a Community, and we are very grateful to them for that.

Thank you to our dedicated committee volunteers for all that you do to help make this event so special...seeking donations, providing unique ideas to make the event special in every way.... Every one of you have been a vital part of this effort and we are very blessed to have you on board.

A special thanks to Betty Ann Catanzaro and her team of artists, who year after year create a Gala decor that is welcoming, fun, unique and truly spectacular in every sense of the word.

To the Jeffery Family: how can we ever thank you for once again donating your beautiful waterfront property to host this event.... under the stars and on the bay, it would be hard to find a more splendid and perfect location for this Gala. You have our sincerest and heartfelt appreciation.

Finally, to Theresa Murphy and her team...what can we say. YOU are the reason this all comes together. Your energy, dedication, and drive to make this happen is seen and appreciated by all of us. Thank you for your unwavering devotion to the cause.

Cheers,

Tom Diffley & Paula Palumbo
Summer Gala Chairpersons

GALA CHAIRPERSONS

THOMAS DIFFLEY
PAULA PALUMBO

HONORARY COMMITTEE

MR. & MRS. MATTHEW C. BLANK
REV. DR. CHARLES CARY
THEODORE B. CONKLIN III
MICHAEL CRUISE
NELSON DEMILLE
MR. & MRS. JOHN R. GAMBLING

MR. & MRS. JOHN KANAS
MARIA Z. MOORE
PETER SARTORIUS
ADRIANA TRIGIANA
CAMERON WINKLEVOSS
TYLER WINKLEVOSS

GALA COMMITTEE

RENEE BARRIERE
EILEEN BOCCIO
EILEEN BROD
BETTY ANN CATANZARO
TINA A. DAVIS
YVONNE ELLIMAN
VICTORIA GARCIA
DR. ALEXIS GERSTEN
MICHELE LEMOEL-GRAY
JANIS GRIM
TOM HADLOCK

VERN HACKWORTH
GEORGIA HATCH
MARY & JOHN HULL
MERYLE KING
MEG KRETZ
MAUREEN LENESE
MISSY LYNCH
URSULA & GEORGE LYNCH
HANNE MANKER
SHEILA MCCAULEY
BECKY MIGNONE

BETTE & FRANK MOONEY
CAROL LEE & JAMES NESPOLE
JO MARIE PICA
ELIZABETH & JOHN PLATE
JUDITH REID
SALLY RICHARDSON
BETSY & DAVID ROWE
LORA SCHIAVETTA
PAULINE SCHMIDT
ALEXANDRA URDANG &
IRWIN MESSER

JUNIOR COMMITTEE

PAIGE ALBERT
OLIVIA AWAD
SOPHIE HEINBERG
GEORGINA HUTCHINS
LIZ HEWITT

HENRY JOHNSON
KIM & TOM OTIS
LIZZIE POND
JACKIE PERROTTA
CHAIRPERSON: HARRISON MESSER

Master of Ceremonies LUCAS HUNT

LUCAS HUNT is the president of HUNT Auctioneers and a celebrated American poet.

He graduated from World Wide College of Auctioneering, is a Benefit Auctioneer Specialist (BAS), and has helped raise millions of dollars for philanthropic organizations, institutions and foundations.





CARE, COMMITMENT, COMMUNITY: The Campaign for EEH

East End Hospice gratefully recognizes the following donors whose support will make the future of EEH and the new EEH Headquarters a reality:

Anonymous (2)

American Legion Auxiliary No 388

Gabrielle Bamberger

Eileen & Frank Boccio

Burner Law Group, PC

The Countess Moira

Charitable Foundation

Mary & Hilton Crosby

Hon. John M. Czygier, Jr.

Dorothy H. Donneson

The Epley Family

Michelle & Peter Halstead

Mary I. and John E. Hull

Melissa Kanas

Emily & Eric Madsen

John T. McLane, Jr.

Gerri & Michael Merlo

Nannette & Anthony Meyers

The Michne Family

Carol Lee & James Nespole

Henry L. O'Brien Foundation, Inc.

Kathleen & James O'Donnell

Rajesh C. Patel, MD

Gail Prudenti & Robert Cimino

Sally Richardson

Bette & Thomas Sturges

Nancy & Robert Treuhold

The Waterhouse Family Foundation

Andy Yaeger

Stanley Zinberg, MD

LEARN MORE about The Campaign for EEH and SUPPORT the EEH Headquarters project with your tax-deductible gift, CONTACT Emily K. Madsen, director of Planned and Major Gifts, at 631.288.7080 or emadsen@eeh.org.

Listing incomplete at time of printing; please forgive any omissions.

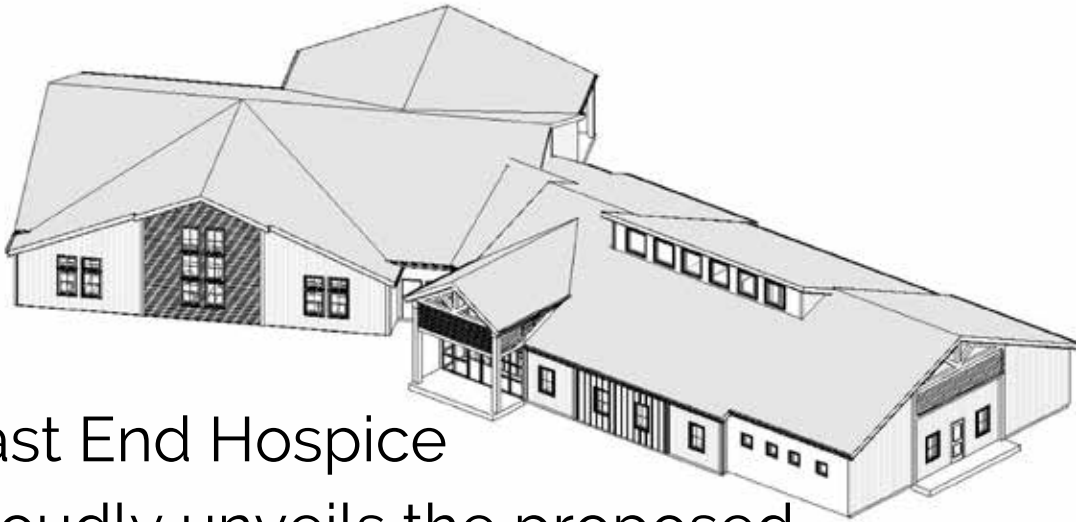

East End Hospice proudly unveils the proposed EEH Headquarters building project.

Located on 2.2 acres at 85 Old Riverhead Road, Westhampton Beach, NY, EEH's new 10,000 square foot headquarters brings satellite locations into a unified village concept that links bereavement, clinical services and administrative functions.

STATE-OF-THE-ART AMENITIES

- Adaptable studio space for children's activities, wellness exercises and programming
- Seminar rooms for community education, programming and staff development
- Large group therapy room
- Private offices for individual and small group counselling

INTENTIONAL DESIGN FEATURES

- Calming, light-filled spaces connected to nature
- Peaceful outdoor greenspace and gardens
- Clinical and administrative functions consolidated to one campus
- Architecture mirrors Kanas Center for Hospice Care design



GOD BLESS
THE VOLUNTEERS

MR. & MRS. JOHN V. BRENNAN



The John and Elaine Kanas Family Foundation

wishes to thank the entire staff of

East End Hospice

for their hard work and dedication to those in need.

We remember fondly our friend, Starr Boggs,

& extend our congratulations to the Otis Family!

It takes a village!

THE KANAS FAMILY



*With great appreciation
to
East End Hospice
for all you do.*

DR. STANLEY ZINBERG



Our heartfelt thanks to
Mary Crosby
and
the staff and volunteers
of
East End Hospice
for their ongoing
compassion and dedication
particularly during the pandemic.

MARY I. AND JOHN E. HULL



With deep admiration for the
kind and caring service of the
EEH staff and invaluable support
of its generous volunteers.

With prayers and thanks to Starr
for his innumerable
contributions to our community.

Blessings and Good Health to All!

FRANK AND EILEEN BOCCIO



**IN LOVING MEMORY OF
ROBERT ALLEN**

Forever in our hearts.

PATTY ALLEN



PATRON LEVEL

*With many thanks to all the
professionals and volunteers of
all the Hospices world wide for the
care and love they provide patients
and their families.*

THE CALCAGNINI FAMILY



**THANK YOU
EAST END HOSPICE
FOR ALL YOU DO.**

KEVIN AND SANDY CROWE



**SADLY OUR COMMUNITY RECENTLY LOST
TWO TALENTED AND AMAZING MEN**

**RESTAURATEUR - STARR BOGGS
AND
ARTIST-DAN POLLERA**

**WE ADMIRE THEIR ACCOMPLISHMENTS,
LOVE OF FAMILY AND FRIENDS
AND THE IMPACT THEY HAD ON OUR LIVES.**

They will be sorely missed.

TOM DIFFLEY



**IT IS WITH WHOLE HEARTED
GRATITUDE THAT WE SUPPORT
EAST END HOSPICE
FOR THE COMPASSIONATE CARE
THEY PROVIDE TO OUR LOVED ONES
& OUR COMMUNITY.**

BARBARA AND JOHN EDWARDS



It is with admiration and respect that
we honor all who work with
East End Hospice for your
dedication and compassionate care.

CRISTINA AND DAVID KEPNER



CONGRATULATIONS TO

PETER HALSTEAD

CHAIRMAN – EAST END HOSPICE
FOR HIS SERVICE AND STEWARDSHIP

WE ARE PLEASED TO SUPPORT
EAST END HOSPICE

NANCY & LUKE LA VALLE



*We are proud to support
East End Hospice.*

TRISH AND PETE MEYERS



**WE ARE PROUD TO SUPPORT
EAST END HOSPICE**

**STARR BOGGS,
THANK YOU FOR THE MEMORIES**

**OTIS FAMILY,
WE ARE SO APPRECIATIVE
OF ALL YOU DO FOR
EAST END HOSPICE**

THE NESPOLE FAMILY



**Our family is honored to support the
East End Hospice and its
dedicated group of caregivers,
counselors, staff and volunteers.
Thank you for all that you do.**

PAULA AND STEVE PALUMBO



WE ARE THRILLED TO
HAVE THIS OPPORTUNITY
TO HONOR OUR FRIENDS

THE OTIS FAMILY

WHO HAVE CONTRIBUTED SO MUCH TO
EVERY FACET OF OUR COMMUNITY

ELIZABETH SHANE
& LOU PIZZARELLO



*With admiration
and gratitude
we support the work of
East End Hospice*

MARY JANE AND TOM POOLE



**PROUD TO SUPPORT
EAST END HOSPICE.**

**BEST WISHES
FOR A
MOST SPECIAL EVENT.**

KEN AND MAGGIE ROSENBERG



**THANK YOU
EAST END HOSPICE
FOR YOUR
CONTRIBUTIONS
TO THE COMMUNITY.**

NANCY & BOB TREUHOLD



Daniel
Gale

Sotheby's
INTERNATIONAL REALTY

To Everyone Involved In Hospice, We Dedicate This Page To You.

As a cancer survivor, I understand the importance of all the compassion and guidance you provide each day. You have guided many of our loved ones on to their next life, leaving us with their handprint on our heart.

In Memory of James Cantwell & Elyse Weissman

XO
Vicky & Niamh



Victoria Reynolds
Associate Real Estate Broker
c.631.834.3440
victoriareynolds@danielgale.com



Niamh Cantwell
Real Estate Salesperson
c.631.603.5609
niamhcantwell@danielgale.com



Westhampton Beach Office | 100 Main Street Westhampton Beach, NY | 631.288.1050 | danielgale.com

Each Office is Independently Owned and Operated. 

BUILDING COMMUNITIES SINCE 1933

H2M is proud to recognize the 2022 Honorees:
Starr Boggs and the Otis Family



East End Hospice
Proposed New Headquarters



architects + engineers

VOTED



631.756.8000

h2m.com



- 📍 New York - Albany | Melville | New York City | Riverhead | Suffern | Westchester
- 📍 New Jersey - Central Jersey | Parsippany
- 📍 Connecticut - Windsor
- 📍 Florida - Pembroke Pines

A Friend to All - Forever Missed

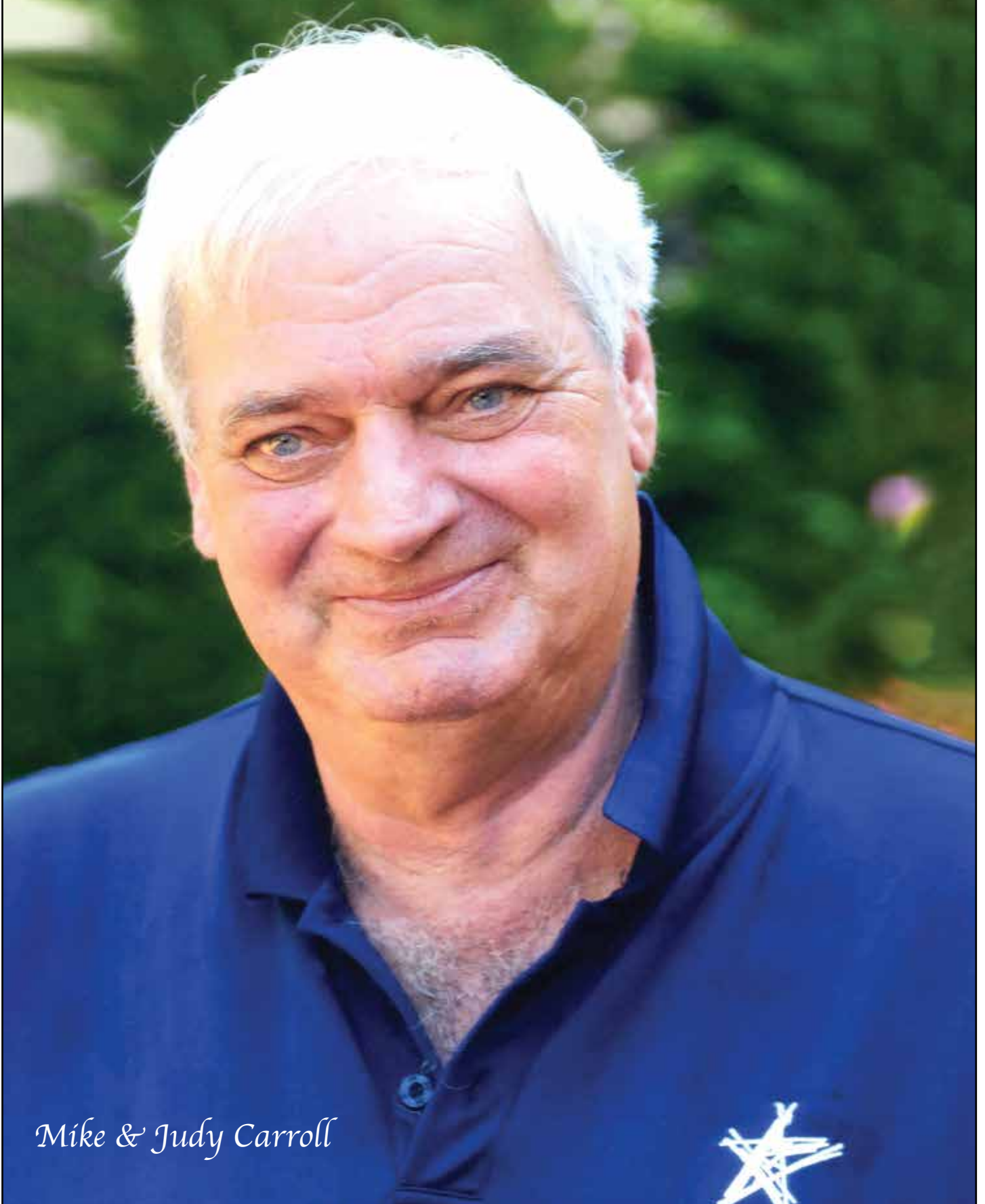

Mike & Judy Carroll



*Experience, Knowledge
and Proven Results*

Dedicated to changing your
FOR SALE property
into a **SOLD** property.

When making an important decision as to buy or sell, it's imperative to work with an agent you trust to educate you on the process. Let that agent be me.

Pat Garrity

Lic. as F. Patricia Garrity
Licensed Associate RE Broker
m : 631.903.5900
pgarrity@corcoran.com

2022 Gold Council
2021 #2 Salerson of the Year - Southampton



corcoran

Real estate agents affiliated with The Corcoran Group are independent contractors and are not employees of The Corcoran Group. Equal Housing Opportunity. The Corcoran Group is a licensed real estate broker located at 24 Main Street, Southampton, NY 11968.

"We make a living by what we get
We make a life by what we give"

- Sir Winston Churchill



image by frank roccanova

*To all who give tirelessly to East End Hospice
Thank you and congratulations
Bobbie Braun and the Neuwirth Foundation*

Thank You

**TO THE EAST END HOSPICE
FOR YOUR HARD WORK
AND DEDICATION.**



ALEXIS GERSTEN, DDS | JASON PARLI, DDS

DENTAL IMPLANTS • COSMETIC DENTISTRY • SMILE DESIGN • INVISALIGN

MODERN DENTISTRY FOR EAST END FAMILIES

631.325.0731 | www.hamptonbeachdental.com

hamptonbeachdental.com • 195 Montauk Highway, Remsenburg-Speonk, NY 11972



THE BROTHERS OF
OLD TOWN LODGE #908 F. & A.M.

40 MAIN ST. SOUTHAMPTON NY 11968

Salute the Staff
of



...and we applaud them
for the Vital Service and Tender Mercies
They Provide
To the Patients & Families
In Their Care
During Life's Most Difficult Times

May The Great Architect of the Universe
Ever Guide Thy Hearts and Hands!



EAST HAMPTON LIONS CLUB FOUNDATION

P.O. BOX 1278
WAINSCOTT, NY 11975
Since 1949, "We Serve"

**PROUD TO SUPPORT
EAST END HOSPICE**



EW HOWELL
CONSTRUCTION GROUP
BUILD SIMPLY.

130
YEARS

EW Howell
is proud to support
EAST END HOSPICE
A NIGHT
UNDER THE
STARS GALA



For more information contact:

Howard Rowland, CEO or
John Finamore, Director of Business Development
516-921-7327, jfinamore@ewhowell.com
WWW.EWHOWELL.COM

RAYNOR COUNTRY DAY SCHOOL & SUMMER CAMP

**Apply now for Pre K - - 6th Grade
& Summer Camp!**



Small Class Sizes
Differentiated Academic Instruction
World Languages
Manners/Etiquette
Chorus & Instrumental
Fine Arts & Dance Program
Musical Theatre for all Students
Physical & Character Education
Before- & After-School Programs



Character

Culture

Community!



**See what all
the buzz is
about!**

Private School Makes A Difference

P.O. Box 380, Westhampton

Visit our Facebook Page: [RaynorCountryDaySchoolandCamp](#)

631.288.4658

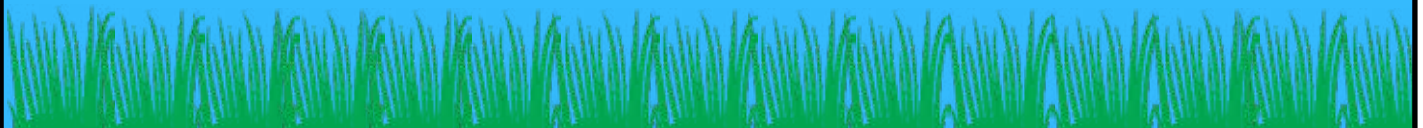

SALES - SERVICE - PARTS - AUTO BODY

OTIS *Ford*

QUOGUE, NY • EST 1946

THANK YOU TO EAST END HOSPICE
FOR ALL THAT YOU DO FOR
THE COMMUNITY WE'RE SO PROUD
TO BE A PART OF FOR 75 YEARS!



www.otisford.com



 /otisfordinc

631-653-4000

 @otisfordinc

32 Montauk Highway "At the Light" in Quogue, NY



WE PLEDGE

**to provide the latest technology and treatments available,
so you have the best opportunity to conquer your cancer.**

*If you or a loved one has been diagnosed with cancer call us today.
We pledge to have all new patients see one of our physicians within 48 hours.*

As a premier cancer treatment center with the most experienced doctors, we are committed to providing the best cancer care possible. From state-of-the-art equipment to cutting edge clinical trials, we are uniquely capable of caring for New York and beyond.



**NEW YORK
CANCER & BLOOD
SPECIALISTS**

Conquering Cancer Together™

a partner of  **OneOncology™**

25 LOCATIONS: SUFFOLK • NASSAU • BRONX • QUEENS • MANHATTAN

NYcancer.com

New Patient Hotline: 1-833-CANCER9





Congratulations to this year's honorees the Starr Boggs & Otis Family. We appreciate the wonderful work that East End Hospice provides to the community.

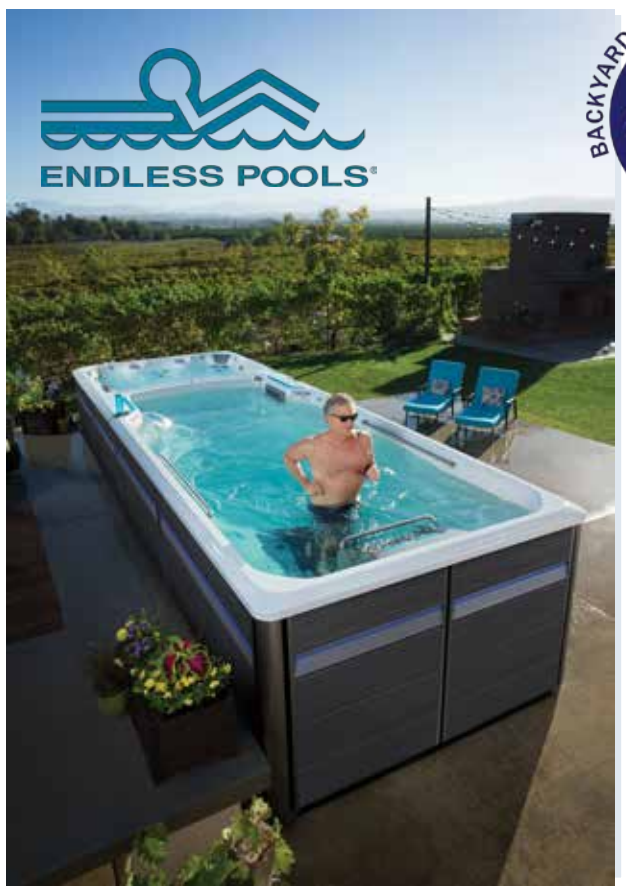

Ocean Spray is the leading Wellness & Spa Dealer on Long Island.

- Hot Springs Hot Tubs
- Finnelo Finnish Rock Saunas
- Endless Pools Fitness Systems

WestHampton Beach • Melville
oceansprayhottubs.com

Follow on social @oceansprayli





Morgan Stanley

PRIVATE WEALTH MANAGEMENT

Morgan Stanley
Private Wealth Management
Is Proud To Support
East End Hospice

Trish Metz

Executive Director
Private Wealth Advisor

1585 Broadway
New York, NY 10036
212-761-5128
trish.metz@morganstanleypwm.com

A huge thank you to
“The Jeffery Family”
for hosting East End Hospice
annual benefit this year



**EAST END HOSPICE BOARD OF DIRECTORS,
STAFF, VOLUNTEERS AND SUMMER GALA COMMITTEE**





SEA LEVEL CONSTRUCTION, INC.

WESTHAMPTON • NEW YORK

We are proud to support



SEA LEVEL CONSTRUCTION, INC.
23 Jagger Lane, Westhampton, NY 11977

Phone: 631-288-8840 / 631-288-4293 | Fax: 631-288-2941

Email: info@sealevelconstructioninc.com

www.sealevelconstruction.com



SAVE THE DATE



Box Art: Daniel Polera
1953 - 2022

Box Art Auction 2022 SATURDAY AUGUST 27

Prominent artists from our community transform either a wine box or a cigar box to create unique, collectible works of art.

**GREAT ART FOR
A GREAT CAUSE.**

TO BENEFIT EAST END HOSPICE



**ST. LUKE'S HOIE HALL
18 JAMES LANE, EAST HAMPTON**

For sponsorship opportunities
or info please call **631.288.7080**
or tmurphy@eeh.org

AUCTION PREVIEW

Wednesday & Thursday
August 24 & 25 • 10 am – 4 pm

PREVIEW RECEPTION

Wednesday, August 24 • 5 – 7 pm
To view more boxes please
visit eeh.org.

SILENT AUCTION & RECEPTION

Saturday, August 27 • 4:30 pm

LIVE AUCTION CONDUCTED

BY LUCAS HUNT 6:00 pm

The **SPIRIT OF COMMUNITY AWARD**
will be presented to **BOBBIE BRAUN**.

IN MEMORIAM

Dan Pollera

1953-2022



**A DEAR FRIEND AND ACTIVE SUPPORTER OF
EAST END HOSPICE FOR MANY YEARS**

**YOUR SMILE, HUMILITY, LOVE OF FAMILY AND
IMMENSE TALENT WILL NEVER BE FORGOTTEN**

**WE ARE SO VERY BLESSED
TO HAVE KNOWN YOU**



Long Island, New York U.S.A.

Peggy Jayne, President 2021-2022

Kelly Holodak

publications marketing branding & identity trade shows & events occasion invitations



kellyholodak.com

East End Hospice is pleased to offer

CAMP GOOD GRIEF

A THERAPEUTIC BEREAVEMENT DAY CAMP FOR CHILDREN,
AGES 4-17, WHO HAVE EXPERIENCED A LOSS

July 25-28, 2022

Rotary Club of the Moriches Camp Pa-Qua-Tuck in Center Moriches,
New York. Please register your camper online starting April 13, 2022
at www.eehcampgoodgrief.org, for more information,
please call Angela Byrns at 631.288.8400.

NO FEES • The cost is underwritten by proceeds from the East End Hospice
Thrift Shop, Valentine Salon, Summer Gala, community grants, and donations
from generous businesses and friends.



East End Hospice | 481 Westhampton-Riverhead Road | PO Box 1048 | Westhampton Beach, NY 11978-7048 | www.eehcampgoodgrief.org

*A **Heartfelt** thank you to East End Hospice...
for bringing comfort to so many people and
making the world a better place.*



*Douglas R. Mathie & Barbara A. Davidson
Horton-Mathie Funeral Home
Greenport, NY 11944*

Camp Good Grief Back For 25th Summer



Since 1997, Camp Good Grief, a bereavement camp for grieving children and teenagers, has offered a safe place for children to express their emotions and talk about their loss, while also engaging in fun traditional camp activities.

The one-week camp run by the East End Hospice of Westhampton is entirely free for all campers and takes place at Camp Pa-Qua-Tuck in Center Moriches, a summer camp for kids with special needs run by the Moriches Rotary Club.

Camp Good Grief was first developed in 1997 by a nurse practitioner, a social worker, and an art therapist who found that grieving as a child is especially difficult, and giving children a safe place to talk about their loss with others like themselves could help dissipate feelings of loneliness.

“When people are grieving, it’s obviously difficult to deal with your own emotions, and then to have to try to explain the grieving process and be present for a child is very difficult to do,” Camp Director Angela Byrns said. “Children, they’re often considered the forgotten mourners, so really just to recognize that they do have feelings, they do have understanding, and to give them a space to be able to express that is what we do here at Camp Good Grief.”

Ms. Byrns explained that research shows that children and teenagers typically don’t start expressing their grief until two years after they deal with loss, meaning they put off their grief and bottle up their emotions for much longer

than adults do. At Camp Good Grief, children aren’t forced to express their grief, but rather given the opportunity to express it in different ways, whether it be verbally, through art, or through music.

“It’s important for kids to have the space to talk about their loss because a lot of the time they feel like they can’t talk about it,” Ms. Byrns said. “They’re not necessarily going to talk about it with their friends, and they may or may not even talk about how they are feeling with their family. Often kids will hold back because they can see that their parent or guardian is grieving and they don’t want to add to that or be a burden.”

At Camp Good Grief, a typical day consists of group therapy, art therapy, and pet therapy, which are all based in therapeutic frameworks and the research of many psychologists who have found that these activities are beneficial in the grieving process, she explained.

“All of the activities that we do have a certain goal, whether it’s getting to know a camper, looking at their feelings, learning how they cope with loss, and then giving kids the opportunity





to talk about the person who they lost and even bring in a picture to talk about that person," she said.

While most of the activities are therapeutically based, Ms. Byrns also emphasized the importance of play. The camp incorporates activities of choice like swimming, drumming, boating, archery and soccer, and special events like puppet shows or magic shows at the end the day to send campers off on a positive note.

"It's definitely a therapeutic camp, but when people come they are surprised to see that kids are running around and smiling and laughing," Ms. Byrns said. "There's definitely tears, and lots of different feelings of sadness, but there's also happiness — which is an incredible thing."

Ms. Byrns, who has been working for East End Hospice for 17 years and first became involved with Camp Good Grief in 2012, said that camp is consistently her favorite week of the year.



"When people ask what I do for a living and I tell them what I do, people do a double take and take a step back," she said. "But camp is such a special place that it's hard to put it into words."

Part of what makes camp so special is the deep sense of community that it fosters among the children who often return to camp for multiple summers, and then end up becoming youth volunteers, and later on adult volunteers.

"Often what ends up happening is they end up becoming a youth volunteer because they know how helpful it was for them to have the camp experience when they were younger, and they want to give that to other children," Ms. Byrns said. "When you have something like that happening, where these kids continue to come back and want to volunteer their time for something that they felt helped them, I think it speaks for itself."

Former campers often call to ask "Do you remember us?" and to talk about how fun camp was, and how much it helped them through a tough time, she said.

"Another thing I hear really often is former campers saying they might even consider a different kind of profession because based on their experience here at camp, they see the benefit of working specifically with children," she added.

Jillian Vargas first attended Camp Good Grief, which was on Shelter Island at the time, after her father died when she was 8 years old. She cited the "loving community" as her reason for returning to camp for two more years as a camper, and then becoming a counselor in 2016 when she was 16 years old.

"It was a whole camp of children who had gone through the same thing as me," Ms. Vargas said, looking back on her years as a camper. "I just remember feeling like it was okay to talk about my loss with others who could really relate."

Ms. Vargas said that the fact that a lot of the counselors now have also been campers in the past is truly the strongest testament to just how great the Camp Good Grief community is.

"Camp Good Grief is the best week of my summer no doubt," she said. "This year, I'm so excited to be with the little kids, and to be able to help anyone, in any way I can, even if it's just being there to listen, is the most amazing feeling."



Memorial Rock Garden

The Mignone family who wanted to remember the life of their dear friend, Kevin P. Kretz, conceptualized a memorial rock garden which will serve as a therapeutic and soothing environment in which patient families, friends and others find comfort while honoring their loved ones. With their determination and creative resources, the Mignones quickly made the garden a beautiful reality thanks to generous donations from their family members and friends.

The Memorial Rock Garden provides a lasting opportunity to remember loved ones while supporting East End Hospice's mission of providing expert hospice care to all who need it. Nestled amongst native plantings and fountains, the Memorial Rock Garden prominently features engraved river stones of those being remembered.

You Can Help Our Memorial Rock Garden Grow

For a \$250 donation, you can dedicate a personalized stone engraved with the name of the person you are remembering, and create a permanent legacy in our Memorial Rock Garden. It's a beautiful tribute to a person that held a special place in your life. Your donation helps provide for upgrades, improvements, ongoing maintenance and support for programs that enhance the care provided at our state-of-the-art hospice facility, the only facility of its kind on the East End

Order your engraved stone online at www.eeh.org/donate

For more information call Christine at 631.288.7080 or email cmichne@eeh.org.





East End Hospice is dedicated to improving lives across Eastern Long Island through expert care, comfort, and compassion for terminally ill patients and their families.



HOME HOSPICE SERVICES

EEH develops an individualized plan of care for every patient in consultation with the patient's primary care provider and EEH's Medical Director. The plan includes nursing, personal care, social work and emotional support for the patient and their caregivers, as well as equipment and medications.



KANAS CENTER FOR HOSPICE CARE

Since 2016, EEH's inpatient facility has accommodated patients whose pain or symptoms are better managed with round-the-clock nursing and equipment that can't be brought into patient homes. The Kanas Center for Hospice Care is the East End's only dedicated hospice facility.



ZINBERG FAMILY BEREAVEMENT CENTER

Grief and Bereavement counseling including individual, group, art, music, equine, Spanish-language therapy, Camp Good Grief and special programs, is available to anyone in the community, including the families of our Hospice patients. More than 250 community members find comfort and support through the Zinberg Family Bereavement Center each year.

Phone: 631.288.8400 **Web:** eeh.org **Email:** info@eeh.org

A NIGHT UNDER THE STARS



CCS Fundraising is honored to sponsor East End Hospice for this year's Annual Summer Gala. We are proud to support this incredible organization.

Best Wishes,
Sarah Castro, Carl Cervi and Tom Kissane



We partner with nonprofits for transformational change

CCSfundraising.com | info@ccsfundraising.com | (212)-695-1175



Theory

OUTLET

200 Tanger Mall Drive · Suite 814

TheoryOutlet.com



EAST END HOSPICE GOLF OUTING
NORTH FORK COUNTRY CLUB, CUTCHOGUE, NY
THURSDAY, SEPTEMBER 1, 2022
CHAIRPERSON JOHN A. KANAS JR.

For sponsorship opportunities or info,
please call 631.288.7080 or email ddoyle@eeh.org

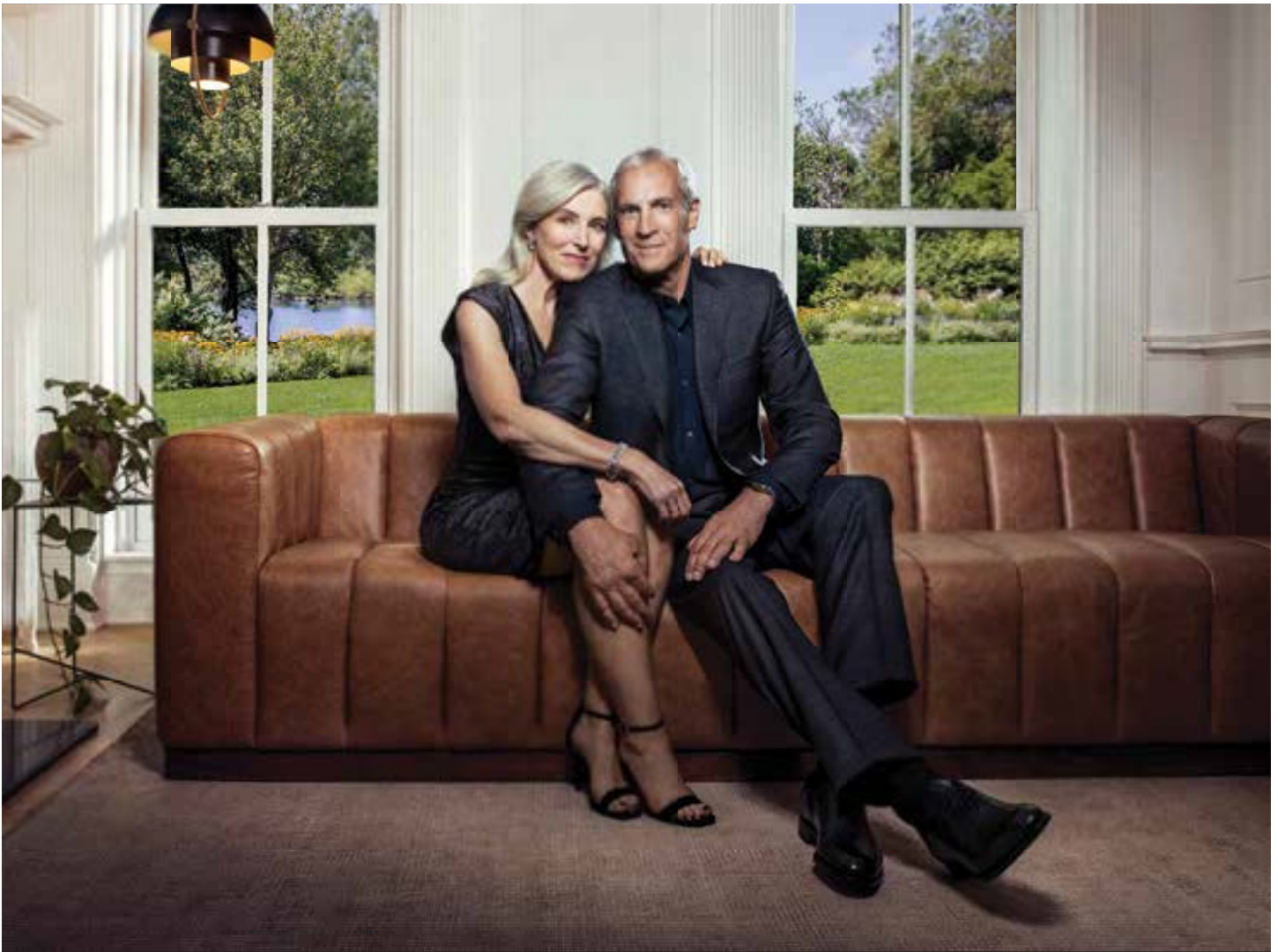

YOU HEAR IT'S A SELLER'S MARKET, AND YOUR HOME MUST
BE WORTH A FORTUNE.

FIRST GET YOUR PRICING STRATEGY RIGHT, THEN SEE WHAT
THE MARKET SAYS.

The pricing discussion can be a real eye-opener. What you see in your home isn't always what potential buyers see, or what the market says. The ability to price a home is something the agents at Brown Harris Stevens consistently get right, which is why they've achieved the highest average sales price per agent in the U.S. according to Real Trends.

Mastery OF THE *Craft*

**Brown
Harris
Stevens**

Congratulations & Best Wishes to

The Otis Family

thank you for your Dedication & Commitment
to our community

&

In memory of

Starr Boggs

you will be greatly missed by so many.



WILLIAM C. AND JOYCE C. O'NEIL
CHARITABLE TRUST

Hollis F. Russell
John C. Crabill
Trustees

PROUD TO
SUPPORT
EAST END
HOSPICE



Commercial Printing
Graphic Design
Direct Mail



Website Design & Development
Digital Marketing
Social Media & SEO

.....
www.searlesgraphics.com | 631.345.2202 | www.searles.media
.....

Making Bereavement Support Accessible To All



Betty Duran, LMSW and Jean Behrens, LCSW-R at East End Hospice. DANA SHAW

In the three years that Jean Behrens, a licensed clinical social worker, has worked as the adult bereavement coordinator for East End Hospice, there's been a goal she and her colleagues have been intent on achieving that has been, frustratingly, difficult to accomplish.

Until now.

Last month, the Westhampton Beach-based nonprofit — which provides care and support services for terminally ill individuals and their families — announced it would begin offering bereavement group therapy in Spanish, opening the door for Spanish speakers to access the same kind of group counseling and support services the organization has long offered in English.

“It’s something we’ve always talked about,” Behrens said in an interview last week.

According to Behrens, several obstacles have stood in the way of putting a Spanish-language bereavement group together for the last few years, even as she and her colleagues understood it would be a vital service to the greater East End community. As is always the case with any nonprofit, funding is typically tight, and the

organization also needed to find — and budget the funds to pay — a bilingual social worker who could not only run the program, but take charge of all the work that goes into putting a bereavement group together, from intake interviews to running the group meetings.

East End Hospice was able to secure funding through a grant from a generous foundation (the organization’s public relations coordinator, Christine Michne, said they were not at liberty to say which organization), which was key in getting the program off the ground, Behrens said.

That’s where Betty Duran comes in. Duran has been working with East End Hospice for nearly a year now, and her ability to speak both fluent English and Spanish has made her the keystone of the outreach. Her ability to do the intake procedures, which are particularly important but also time consuming, has been vital, Behrens said. East End Hospice will spend an hour or more with individuals seeking services, determining the ins and outs of their particular set of circumstances and needs in order to best serve them.

Duran hails from Bay Shore, but is part of a family that originally came from El Salvador, and Spanish was her

first language. She is deeply connected to the Spanish-speaking population in Suffolk County, having done in-home therapy with the Family Service League, and she still works at the mental health clinic in Central Islip, where her dual language skills are an important asset. She understands almost better than anyone how a Spanish-language bereavement group can benefit the community, particularly in the wake of the COVID-19 crisis.

“There really is a big need for this,” she said.

Duran pointed out that in addition to speaking the language, she also has the “cultural competency” that makes her uniquely qualified to understand the needs of Spanish-speaking families and individuals who are processing the death of a loved one and trying to work through their grief in a healthy way.

“I would go to El Salvador every summer, and whenever I saw death and funerals and different services, it was very community based,” Duran said. “And it’s very community based here, too.”

Duran said that despite those kinds of community-based traditions surrounding death in many Spanish-speaking cultures, there can often be a flipside of loneliness when it comes to the ongoing grieving process that takes place after the funeral ceremonies are over.

“In the Hispanic community, feelings are not always expressed,” she said. “You might have support, but it doesn’t mean you’re sharing all your emotions. This group will give [Spanish speakers] a space to share with others.”

Duran also pointed out that the group therapy will be provided free of charge, and that privacy is taken seriously, two factors that East End Hospice hopes to emphasize particularly to reassure any undocumented Spanish speakers who may be interested in attending.

“People need to know that it’s a very confidential process,” Behrens said, keen to emphasize that point. “When people come to us, we do paperwork, but it goes nowhere. We’re not a mental health clinic, we’re a counseling support system. No one has access to anyone’s information. It’s very private. There’s nothing different about it than if they were to go talk to someone at their church.”

Duran, Behrens and the rest of the team at East End Hospice are still in the beginning stages of doing community outreach and putting the word out that Spanish-language bereavement services are now being offered. Duran said they’re trying to make everything as accessible as they can, from translating all the forms into Spanish, doing in-take sessions, and getting referrals of people who may be interested in the group therapy from

various other community organizations.

The hope is to start offering the group session on Tuesday evenings, from 6 to 7:30 p.m., initially over Zoom but with the possibility that they might take place in person in the future.

Duran also pointed out that anyone who is grieving the loss of a loved one is welcome, and that the group is not only for people whose loved ones were in hospice care. Whether someone watched a loved one go through a months- or years-long battle with a terminal illness, or lost a family member or close friend suddenly or unexpectedly, the group is open to anyone seeking support as they move through the grieving process.

The need for a Spanish-language bereavement group has existed for a long time, but the pandemic made that need even more acute. With many other groups and organizations that offer a wide range of support and mental health services experiencing long wait lists or wait lists so long that they don’t even offer spots on them any more, the group could not come at a better time.

“The calls we’ve been getting through our office have been so sad,” Behrens said. “People telling us that the waiting lists [to speak with someone] are endless or just never getting a call back from a mental health agency. People have been practically begging us to see them because no one will. That’s what’s going on in the English-speaking world. I can’t even imagine the thoughts that go through someone’s head if they’re Spanish-speaking only. The Spanish-speaking agencies are there, but they’re smaller and they’re overwhelmed.”

Duran and Behrens hope that more Spanish-speaking people will hear about the group counseling through word of mouth, and that it will grow that way, becoming a valuable resource in the community. And while doing all the intake interviews for individuals and also running the group is a lot of work for one person, Duran said she’s happy to do it because it will help her forge strong connections with the people seeking out help, and will give her the kind of insight to help people get the most out of the group therapy setting.

For Duran, the goal in setting up the group is simple.

“We’re very much on a mission to meet everyone where they’re at,” she said. “For many people, this will be their first experience with a group counseling setting, being in a group, sharing with other people. I’m going to do my best to make people feel comfortable.”



Riverhead
Rotary Club
Supports
East End Hospice

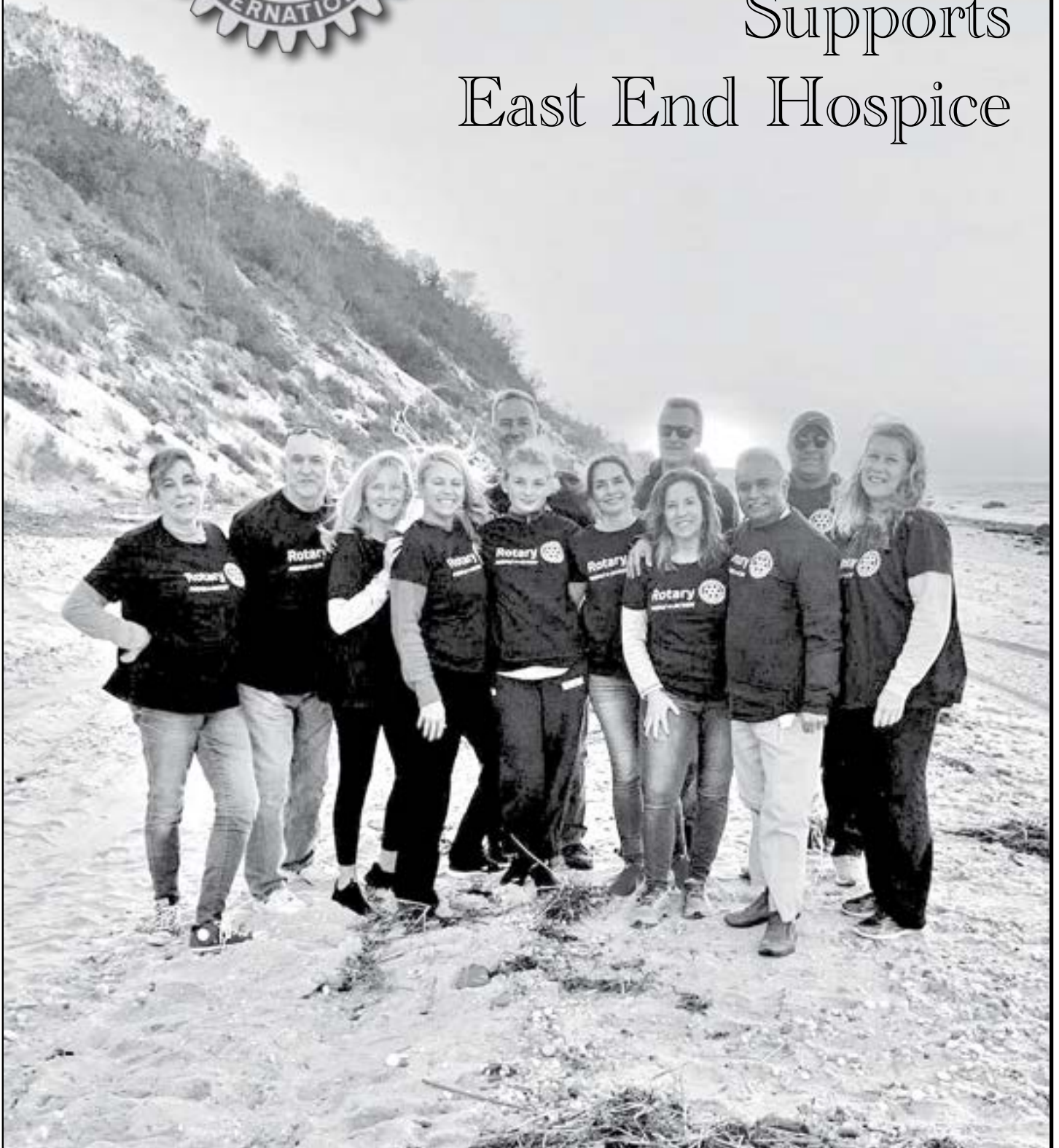

HAMPTON PEST

management

Many thanks to
THE OTIS FAMILY
for their exceptional
contributions to
our community!!

631.728.1708

www.hamptonpestmanagement.com

Thank you to the wonderful East End Hospice Volunteers 2022

Jennifer Ashley	Colleen Gilmartin	John O'Keefe
Linda Aydinian	Corinne Gilmartin	Paula Palumbo
John Balzer	Daniel Gilmartin	Ellen Pearlman
Connie Best	Edward Greenberg	JoMarie Pica
Greg Blass	Alicia Grice	Ken Pickett
Susan Bloom	Joann Hackett	Helene Pickett
Julia Brandt	Pat Hammill	Suzette Raffel
Patricia Brandt	Katie Hammond	Sandy Raynor
William Brandt	Dennis Hogan	Faye Robins
Susan Brigham	Susan Holmes	Susan Ruocco
Carol Carroll	Joseph Hurley	Janet Sanford
Francis Carroll	Inge Izzi	Therese Sargent
Olivia Cassara	Carol Johns	Caitlin Saxtein
Sharmila Cohen-Gold	Eileen Kalmus	Lauren Scanzano
Louise Cox	Zoe Kamitses	Joann Schmitt
Eve Crespi	Nelann Kempton	Marietta Seaman
M. Doreen Croser	ClaraSue Kettenbeil	Daina Shaw
Margaret Cruise	Bernadette Koch	Michael Shaw
Michael Cruise	Marsha Kranes	Patti Sheehan
Patrick Cuff	Joseph Lamport	Theresa Sinopoli
Grace Daly	Chris Lang	Louise Smith
Peggy DeMayo	Holly Lanzetta	William Stafford
Randi Dickson	Elizabeth Lignon	Barbara Stuchinski
Beverly Dixon	Deena Lippman	Megan Swift
Judy Doll	Marlene MacVicar	Joseph Taranto
Colleen Doumeng	Patricia McCormack	Anne Thomasino
Deborah Doyle	Christina McCoy	Jillian Vargas
Paul Eglevsky	Marcella McLoughlin	Irene Webb
Mary Lou Emmons	Catherine Medina	Jacalyn Weinstein
Elizabeth Fasciana	Geraldine Merlo	Donna Wexler
Gaia Filicori	Philip Metzger	Ellen Wiener
Mindy Fortin	Nannette Meyers	Stuart Wood
Lee Foster	Joann Mulcahy	Louise Wood
Alice Froehlich	Margaret Nelson	Jeanne Woods
Janet Gabriel	Cathy Nordt	Anne Zakour
Robin Gage	George Nowell	Ellen Zimmerman
Catherine Gallagher	Annemarie O'Hara	David Zimmerman
Gina Gallagher	Paul O'Connor	

Please forgive any omission, list incomplete at time of printing.



The Raynor Group,
P.E. & L.S. PLLC

*Proud to support
East End Hospice*

Civil Engineers & Land Surveyors

Deerfield Green
860 Montauk Highway
P.O. Box 720
Water Mill, N.Y. 11976

631-726-7600
info@raynorgroup.net



We proudly support
East End Hospice
on the occasion of its
Summer Gala

Thank you for the increased public awareness brought to our local communities and continuing to fulfill East End Hospice's important mission.



Congratulations to all of this year's honorees!

*The Summer Gala Committee wishes to
extend very special thanks to our friends for their generosity*



Anonymous
Atlantic Golf Club
Beach Bakery
Eileen Brod
Brunetti
Burner Law Group
Capital Genealogy
Patrick Carroll
Collins Building Services
Diana's Unique Boutique
Tom Diffley
Fiore di Luna Salon
Fowler's Garden Center
The Gateway
Good Westhampton
Vern Hackworth
The Hampton Classic Horse Show
Hampton Coffee Company
Hampton + Dunes
Hampton Pest Management
Hamptons Aristocrat
Harry Hackett III
Herbert & Rist Inc.
High End Hippie
Kelly Holodak
Island Surf Shop
Jeffery Family
Carol Johns
Justin's Chop Shop
La Carezza
Dr. Karen Lalli
Laurel Links Country Club
London Jewelers
LT Burger
Lynne's Cards & Gifts
Manikur
Marc Chiffert
Mary's at the Olde Speonk Inn
Mill Road Cheese Shop
Mixology
Mustique
Nibi MTK
Palmer & Purchase
Steven Palumbo
Peat & Son
Dr. Tracy Pfeifer
Mr. & Mrs. Vincent Pica
Quogue Field Club
Red Jacket Books
Remsenburg Garden Club
Rico's Clothing
Riverhead Building Supply
Robert Siegel Architects
Rooted Hospitality Group
Rosanti Floor Covering
Salon 2000
Salon East
Pauline Schmidt
Shoe Inn
Six Corners Fine Wines & Liquors
South Fork Bakery
Stone Creek Inn
Stony Brook Southampton Hospital
Stop and Shop
Summer Gala Committee
Tanger Outlet Center
Tate's Bake Shop
Theory
Tobey Nelson
Tola
Vera Bradley
Westhampton Beach Performing Arts Center
Westhampton Country Club
Westhampton Glass
Westhampton T-Shirt
ZYR Vodka

Please forgive any omission, list incomplete at time of printing.

BRIDGEHAMPTON PRESBYTERIAN CHURCH

FOUNDED IN 1670

INSPIRED
BY OUR PAST

ASPIRING
TO OUR FUTURE

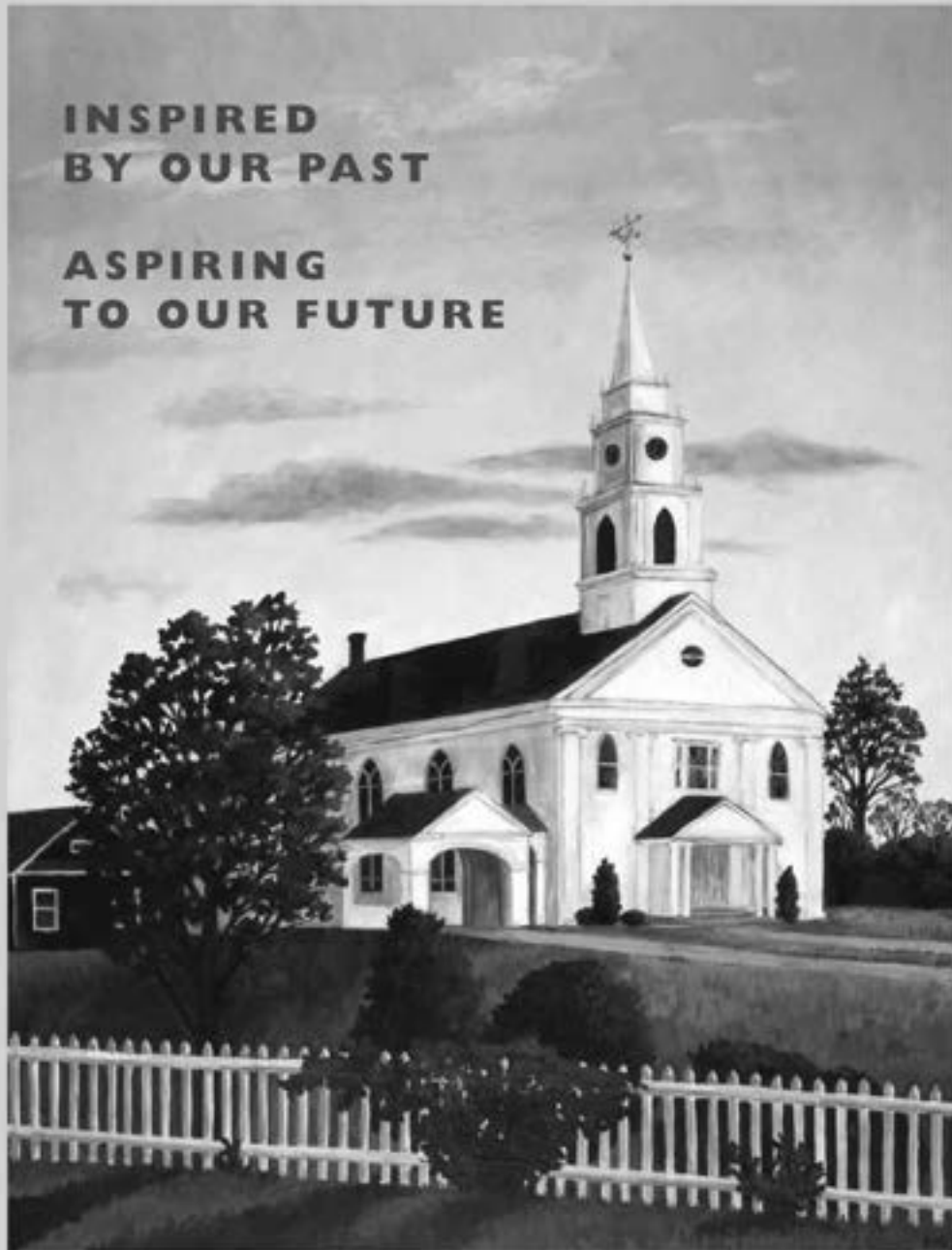

PAINTING BY BARBARA THOMAS

ALL ARE WELCOME

REV. ADRIAN PRATT, B.D.

2429 Montauk Highway
PO Box 3038 Bridgehampton, New York 11932
631-537-0863 office@bridgehamptonpc.org
www.bridgehamptonpc.org

EXPERIENCED.
RESPECTED.
RESULTS DRIVEN.

Your Waterfront and Luxury Real Estate Expert

Rensselaer | Westhampton Beach | Dune Road
Quogue | East Quogue | Hampton Bays



Aimee Fitzpatrick Martin

Licensed Associate Real Estate Broker

☎ (631) 357-0016 | AMartin@Saunders.com



SAUNDERS
A HIGHER FORM OF REALTY

33 SUNSET AVENUE, WESTHAMPTON BEACH

"Saunders, A Higher Form of Realty," is registered in the U.S. Patent and Trademark Office. Equal Housing Opportunity.

TO THE BEST CHEF, FRIEND AND BOSS
REST IN PEACE



Raise a can of Budweiser
Your favorite red wine
Enjoy the meatballs while
cooking the liver and onions



UNTIL WE MEET AGAIN

THE SEAMAN FAMILY
CHUCK, MARIETTA, RENEE AND CHARLIE



The
Quogue Fire Department
congratulates the
Otis Family
for generations of service
to the community
and in the
Quogue Fire Department



Serving Suffolk County for
Residential / Commercial / Industrial

Sales and Service for the following:

- Propane
- 24 Hour Emergency Service
- Aboveground & Underground tanks
- Generators
- Pool & Spa Heaters
- Fireplaces
- Firepits
- Stoves / Cooktops
- Hot Water Heaters



3947 Middle Country Road • Calverton, NY 11933
631-369-4299



BUILD SMARTER. BUILD BETTER.

**SINCE 1948, WE'VE BEEN DEDICATED TO HELPING BUILD
A BETTER COMMUNITY FROM THE GROUND UP.**

Riverhead Building Supply is a Proud Sponsor of East End Hospice



rbscorp.com • 1-800-874-9500

**LIVE YOUR COR FOUNDATION
proudly supports
East End Hospice**

Live Your Cor Foundation

17 Bridle Path, Westhampton Beach, NY 11978 631.288.2527

The goal of the foundation is to "pay it forward" by providing financial assistance to families who have suffered adversity or a personal hardship.

RACHEL LYNCH



SWIMMING POOLS & SPAS

PROUD TO SUPPORT
EAST END HOSPICE

(631) 283-0820
(631) 283-3640 - FAX

375 DAVID WHITE'S LANE
SOUTHAMPTON, NY 11968
WWW.RACHELLYNCH.COM

Propane  **depot**SM
.com

**Why
Pay
More?**

Is Proud to Support

East End Hospice

PropaneDepot.com

631-400-SAVE

Island East management



John M. King III
Ryan King

Specializing in Condominium, Cooperative,
Residential & Commercial Property Management

631.288.6646 • islandeastmgmt.com
25 Sunset Avenue, Westhampton Beach NY 11978



JEWISH CENTER OF THE HAMPTONS

Jewish Center of the Hamptons congratulates

East End Hospice

on outstanding service to the East End.

Rabbi Joshua Franklin Rabbi Debra Stein, Cantor

JEWISH CENTER OF THE HAMPTONS
44 Woods Lane, East Hampton, NY, 11937 | 631-324-9858 | www.jcoh.org

Provisions

NATURAL FOODS MARKET & CAFE

Sag Harbor

Open 7 Days, Year-Round
Bay & Division St, Sag Harbor

631-725-3636

Water Mill

Open 7 Days, Year-Round
760 Montauk Hwy, Water Mill

631-500-9368

Online Shopping and Home Delivery Available.

www.provisionsnaturalfoods.com



Scott Hofmann
Founder
scott@ficomputing.com

Fluid Imagery Computing
631.288.2032

1a Montauk Highway, Westhampton, NY 11977
ficomputing.com

EAST END HOSPICE

**Thank you for all the Love and Care
you selfishly give to Our Community**

***The Officers and Members
of The Southampton Town Police
Superior Officers Association***

Steven Maresca, P.E.
Principal Engineer

S.L. Maresca & Associates
Consulting Engineers

188-04 West Montauk Highway
Hampton Bays, NY 11946
631.728.9480

steve@slmaresca.com • www.slmaresca.com

Proud to support East End Hospice

A Night Under the Stars

Kelly & Hulme, P.C.

323 Mill Road
Westhampton Beach, NY 11978
631.288.2876

Thank you, East End Hospice, for making a difference every day!



Best Wishes from your friends, the Southampton Town Kiwanis Club

Serving the Children of the world. One family / One community at a time!

www. <https://www.kiwanisclubofsouthamptontown.org>

local hand-roasted craft coffee
fresh homemade food & so much more!

- Water Mill
- Westhampton Beach
- Southampton
- Aquebogue
- Montauk
- Center Moriches

a local business proud to be making a difference in our community!

Shop online, get locations and more at
hamptoncoffeecompany.com



(631) 325-0022

Fax: (631) 325-2205

PECONIC

AUTO WRECKERS, INC.

Computer Inventory
N.Y. S. Lic. #7001674

Box 39, Montauk Hwy.
Speonk, NY 11972

. SINCE 1928 .
BRAUN SEAFOOD CO.



FISH MARKET: 631-734-7770

KITCHEN: 631-734-5550

WHOLESALE: 631-734-6700

**LONG ISLAND'S
QUALITY SEAFOOD SOURCE**

30840 MAIN ROAD, CUTCHOGUE, NY 11935

At Apple Bank, we've always believed that a strong community and a strong bank go hand in hand.

We are proud to support East End Hospice and all it does to provide expert care, comfort and compassion to patients and their families.

Apple Bank 

Established 1863 • Member FDIC

applebank.com

Matthew Feeney, VP/Manager
50 Montauk Highway
East Hampton, NY 11937
631-324-6500



Spirits Fire Department proudly supports

East End Hospice

Our Thanks and Appreciation for
Over 30 Years
of Compassionate Care!

PROTECT YOUR FAMILY



**Organic Safe Solutions for
Your Outdoor Pest Problems**

**TICK & MOSQUITO CONTROL
DEER REPELLENT • PARTY SPRAYING
DEER FENCE INSTALLATIONS**

Call For a
Free Estimate!

CHRIS SMITH

631-680-1924

www.healthyestates.com

OWNER OPERATED, FULLY LICENSED AND INSURED,
SERVING THE NORTH FORK AND SOUTH FORK OF LI



The Eastport Fire Department
Members are proud to support

East End Hospice
A Night Under the Stars



EA Eastern American
TECHNOLOGIES

350 7TH AVE. NEW YORK, NY 10001

PHONE (212) 359-9700

35 LARKFIELD RD. EAST NORTHPORT, NY 11731

PHONE (718) 937-3600

ED ENNIS
Tel. (631) 281-9570
Fax (631) 395-5975

ED ENNIS, JR.
CELL (631) 793-7531



**COMMERCIAL • RESIDENTIAL
POWER WASHING**

40 YEARS EXPERIENCE • FULLY INSURED

PRICE RITE PAINTING

"TRY US, WE CARE ABOUT YOU"

107 Somerset Ave., Mastic, NY 11950

*In memory of Helen Ennis, our beloved sister,
bookkeeper, receptionist and our connection
for 20 years to our customers.*

RED ALPERT
631-838-1701

MARIE WILKINS
631-838-1672

**RED-TIE
LIMOUSINE SERVICE, INC.**

**Limousines for Any Occasion
24 Hr. a Day Service**

631-288-0845

P.O. BOX 599

Westhampton, NY 11977

CHIFFERT

ARCHITECTURAL ENGINEERING & CONSTRUCTION SERVICES

53 Hill Street, #18
 Southampton, NY 11968
 Tel: 631.353.3375
 Fax: 631.377.3896

WWW.CHIFFERT.COM



Marc A. Chiffert, P.E.
 President
 Cell: 917.656.9166
 marc@aecengineeringdesign.com

*Thinking of selling
 or renting your property?*



Contact us
The Murray Team
 #1 Sales Team
 Corcoran Westhampton Beach



CORCORAN

Amanda Murray
 Licensed RE Salesperson
 #11 328-0448

Robert A. Murray
 Licensed Associate RE Broker
 #1 431-871-3200

murrayteam@corcoran.com
 murrayteamhampton.com

HAMPTON PROPERTIES



We are grateful for the care and support
 East End Hospice provides to our community.

90 Main Street
 Westhampton Beach, NY 11978
 www.hamptonproperties.com
 631-288-6100



MLS



MEMBER
 New York State Association
 of REALTORS, Inc.

HANFRA

If You're On Long Island You're In



King Kullen Country!
America's First Supermarket

**PROUD
 TO SUPPORT
 EAST END HOSPICE**



HERRICK HARDWARE INC.

**41 MAIN ST., BOX 1401
SOUTHAMPTON, NY 11968
631-283-0026
Fax 631-287-1876**

**Email:
help1@herrickhardware.com**



Quality Glass and Mirror Work
Aluminum Window & Door Systems
Custom Shower Enclosures



Bob Busking



44 Old Riverhead Road
Westhampton Beach, NY 11978
**(631) 288-1727
FAX: (631) 288-1784**

**Celebrating the
wonders of Hospice**

**Dorothy Donneson
& Family**



Local Family Serving Our Communities Since 1922

203 Hampton Road Southampton, NY 631-283-0822
www.brockettfuneralhome.com info@brockettfuneralhome.com



Thomas L. Altman Alan D. Altman



Kiwanis

Kiwanis of Greater Westhampton

Proudly Supports

East End Hospice's
Annual Summer Gala
"A Night Under the Stars"

June 25, 2022

email: whkiwanis@gmail.com
[facebook.com/whkiwanis](https://www.facebook.com/whkiwanis)

**Stephen A. Curtis, D.D.S.
James B. Campbell, D.D.S.**

**516 Montauk Highway,
Suite 2
East Moriches, NY 11940
631-874-4747**



**PROUD
TO SUPPORT
EAST END HOSPICE**

**THANK YOU FROM OUR FRIENDS
IN THE COMMUNITY!**

**Briarcliff Sprinklers
Robcyn Associates LLC
The Olde Towne Garden Club
Sparrow Heating & Air Conditioning
Star Fire Protection Co.**



**PROUD SUPPORTERS OF EEH
1 Cedar Street • East Hampton, NY**

TEL: (631) 653-6390
FAX: (631) 653-6391

EMERGENCY
(631) 727-5943

FORGE HEATING & AIR CONDITIONING CORP.
DESIGN, INSTALLATION AND SERVICE

RUSSELL STREEKER
PRESIDENT
251 Old Riverhead Rd.
PO Box 928
Westhampton Beach, NY 11978



Jerry Anthis
cell 631.681.0271
office 631.728.2059

Woodcliff Park Cottages
Ben & Sandy Karlin
Baiting Hollow, NY 11933

Westhampton
T-SHIRTS
Silk Screening
Embroidery
Lettering

77 Main Street WHB 631-288--9175



NORTH SEA
PLUMBING & HEATING CO., INC.
NORTH SEA WELL DRILLING, INC.
HAMPTON IRRIGATION

524 County Road 39A
Southampton, NY 11968
(631) 283-3876
www.northseaplumbing.com

24-HOUR EMERGENCY SERVICE

Neal Kelly

(631) 288-5098
Cell (516) 768-5288

PAINT IT!

Interior • Exterior • Power Washing

Post Office Box 1566
Quogue, New York 11959-1566
paintit@optonline.net

Elderco, Inc.

Michael Burner
Builder/Developer



W.C. Esp
2141 Montauk Highway
Bridgehampton, NY 11932
631.537.0193
631.537.0267 FAX
wcesp.com

Oil Heat • Propane • Heating
Cooling • Marine Services
Energy Audits • Remote Monitoring

BAGELS-N-BRUNCH

breakfast & lunch

OPEN 7 DAYS

mon-sat 6:00 to 3:30 sun 6:00 to 2:30



catering
boars head meats
homemade salads
daily specials

295 montauk hwy
speonk n.y 11972
631-325-0850

NUGENT & POTTER, INC.



SINCE 1933

DISTRIBUTORS OF PLUMBING AND HEATING,
SWIMMING POOL, IRRIGATION, WELL
AND DRAINAGE SUPPLIES

1557 County Road 39, Southampton, New York 11968
(631) 283-1103 FAX (631) 287-4339

LEE ESSAY • SALES
lee@nugentpotter.com

Complete
Rehab



Barbara Heim, OTR/L

Post Office Box 1025
Remsenburg, NY 11960-1025

Tel: 631.325.6963

Fax: 631.325.2941

email: barbara@completerehab.net

www.completerehab.net

Complete Rehab PT, OT, SLP of the Hamptons, PLLC

Southrifty
Drug

ROBERT E. GRISNIK
PHARMACIST

54 JAGGER LANE
SOUTHAMPTON, N.Y. 11968
WWW.SOUTHRIFTYDRUG.COM
BOB@SOUTHRIFTYDRUG.COM

631-283-1506
800-540-1284
FAX: 631-283-4936



ESSEKS, HEFTER, ANGEL, DI TALIA & PASCA, LLP
COUNSELORS AT LAW

108 EAST MAIN STREET
P.O. BOX 279
RIVERHEAD, NY 11901
TEL: (631) 369-1700
FAX: (631) 369-2065
www.ehalaw.com

Swezey FUEL CO., INC.

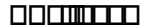

Suffolk's Largest Family Owned Energy Company

- Heating & Air Conditioning
- Automatic Oil Delivery Service
- 24-Hour Emergency Service
- Budget Plans that Pay You Interest
- Plumbing
- Expert Installations of Boilers, Burners, Hot Water Heaters & Air Conditioning Equipment



631-475-0270

51 RIDER AVE.
PATCHOGUE



24 E 2nd St
Riverhead, NY 11901



Congratulations to Liz Plate
for all her years working at
Camp Good Grief! Thank you!

Paul and Lashes

*With great
appreciation
and gratitude,*

Burner Law Group, P.C.
is proud to support
East End Hospice



Elder Law, Estate Planning, Trusts & Estates, Real Estate

East Setauket • Westhampton Beach • New York City • East Hampton

(631) 941-3434 • (212) 867-3520

burnerlaw.com

FOR ALL YOU DO
FOR ALL OF US
WE THANK YOU
FROM THE BOTTOM OF OUR HEARTS

EAST END HOSPICE - KANAS CENTER - CAMP GOOD GRIEF

YOU ARE OUR HEROES

KERRIGAN
COUNTRY REALTY



631.288.9600

KERRIGANCOUNTRYREALTY.COM



HAMPTON TITLE SERVICES

Westhampton Beach, NY - 631.248.0001